

Body Pro-Lok ONE™ System on iBEAM® evo Couchtops with evo Adapter

Patient:

Date:

Notes:

Important instructions, please read:

When transferring a setup from the Universal Couchtop™ or ONEPlatform™ to the iBEAM evo Couchtop with the Body Pro-Lok ONE evo Adapter, reference Appendix A for available setup regions.



evo adapter

1 Respiratory Plate (check all that apply): Standard Wide ComfortCare™ Cushion

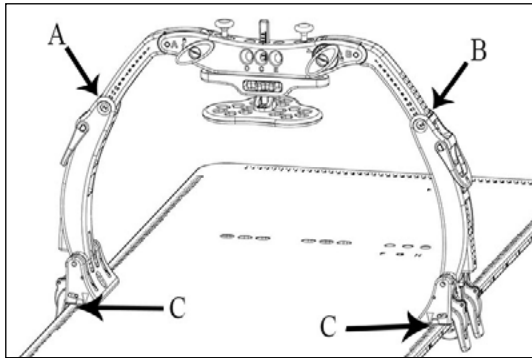

Body Pro-Lok ONE evo adapter (check if utilized)
 evo Couchtop indexing:
 (Example: 3 C 4; See Appendix A Reference Sheet)

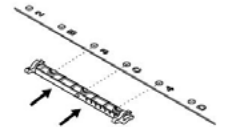

A) ONEBridge™ Side A:
 B) ONEBridge Side B:
 C) Docking Index:

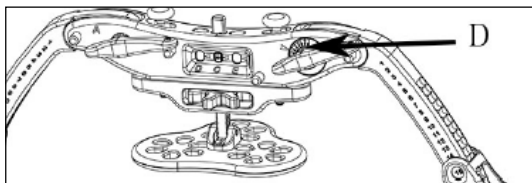

D) ONEBridge Lateral Position:

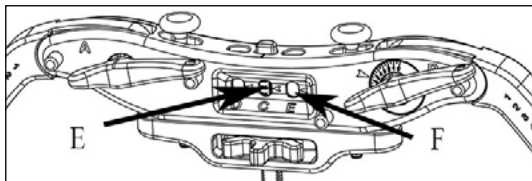

E) Respiratory Plate Height:
 F) Respiratory Plate Lateral Position: D C E

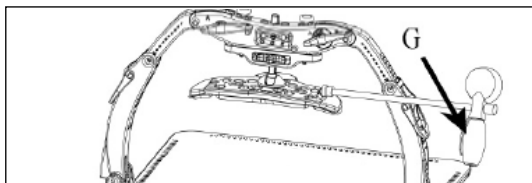

G) Set pressure between: and
 (only if using ComfortCare Cushion)

2 Respiratory Belt (check if utilized)

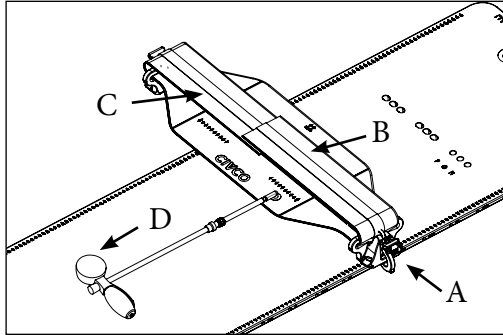

Body Pro-Lok ONE™ evo adapter (check if utilized)

evo Couchtop indexing:

(Example: 3 C 4; See Appendix A Reference Sheet)

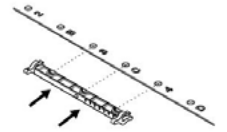

- A) Docking Index:
- B) Left velcro strap indexed at: -
- C) Right velcro strap indexed at: -
- D) Set pressure between: and

3 Clam-Lok™ Cushion (check if utilized)

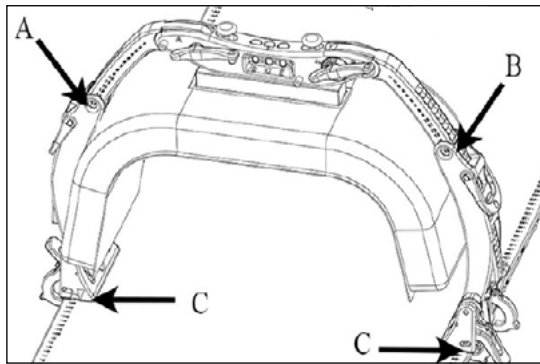

Body Pro-Lok ONE evo adapter (check if utilized)

evo Couchtop indexing:

(Example: 3 C 4; See Appendix A Reference Sheet)

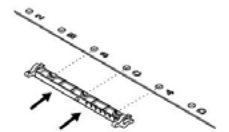

- A) ONEBridge™ Side A:
- B) ONEBridge Side B:
- C) Docking Index:

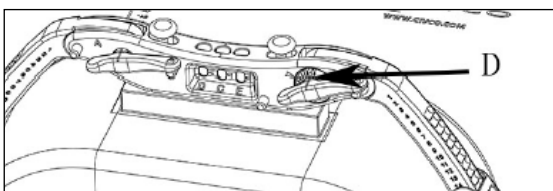

- D) ONEBridge Lateral Position:

4 Forehead Brace (check if utilized)

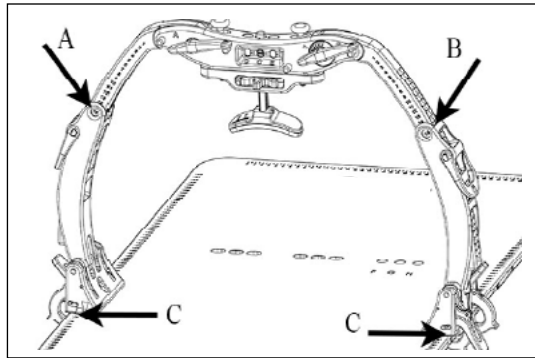

Body Pro-Lok ONE™ evo adapter (check if utilized)
evo Couchtop indexing:
(Example: 3 C 4; See Appendix A Reference Sheet)

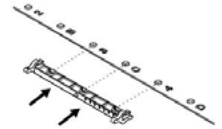

A) ONEBridge™ Side A:
B) ONEBridge Side B:
C) Docking Index:

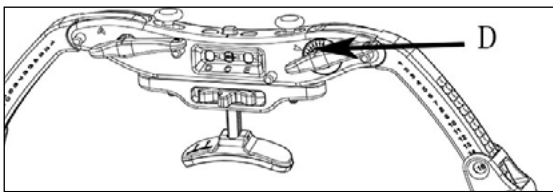

D) ONEBridge Lateral Position:

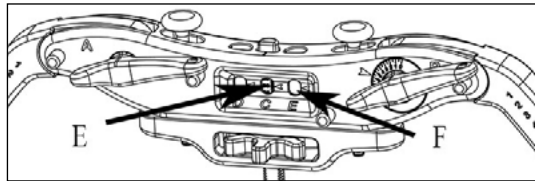

E) Forehead Brace Height:
F) Forehead Brace Lateral Position: D C E

5 Additional indexable accessory:

Indexed at:

6 Additional indexable accessory:

Indexed at:

7 Additional indexable accessory:

Indexed at:

8 Additional indexable accessory:

Indexed at:

Appendix A: evo Adapter Indexing Example

Blue box enlarged to show indexing detail.
Grey indicates non-indexable areas.

ONEPlatform or
Universal Couchtop evo
Couchtop

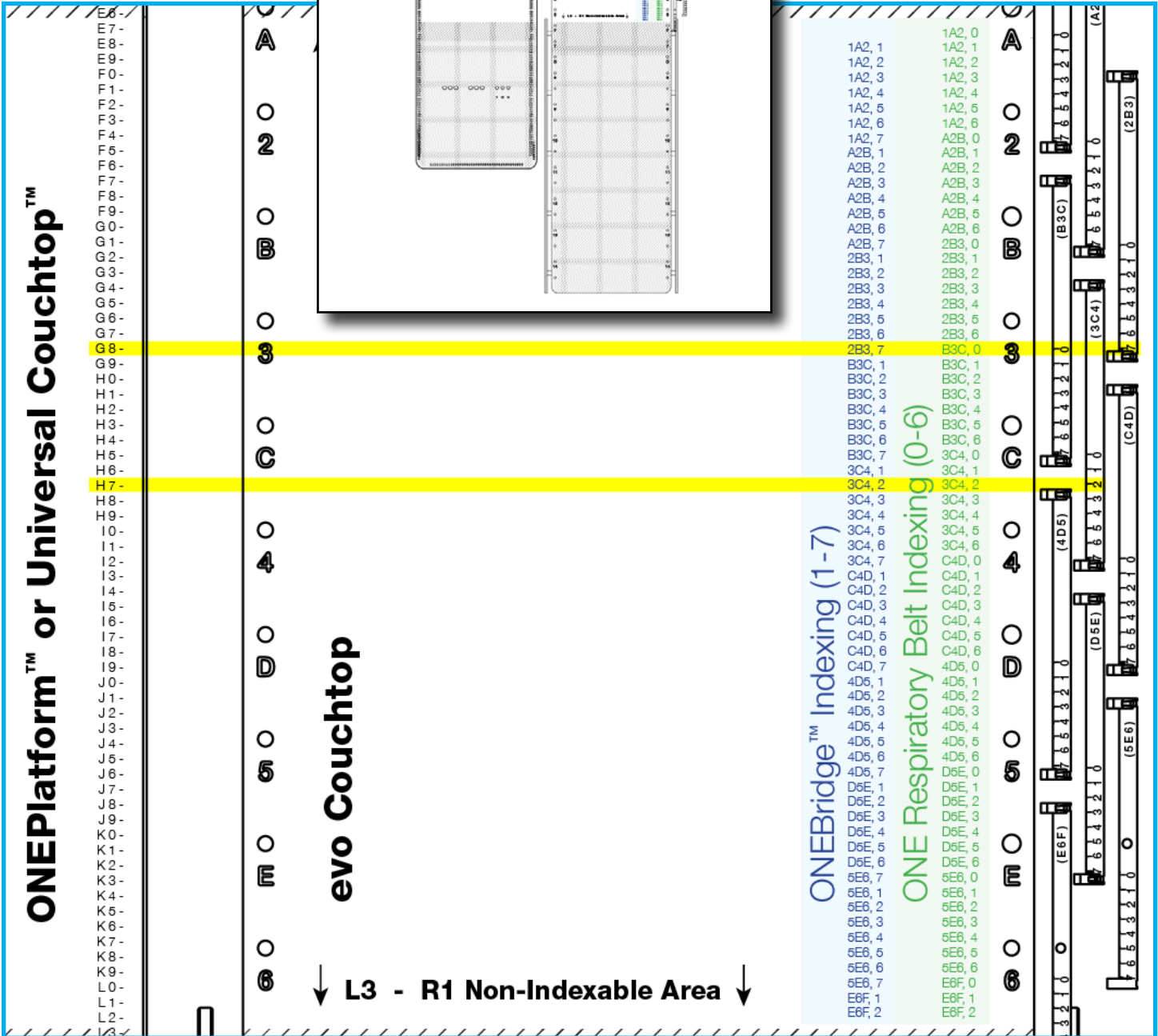
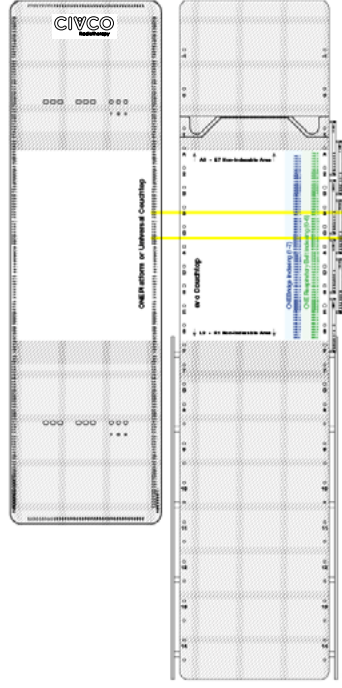

Body Pro-Lok ONE™ System iBEAM® evo Adapter Reference Sheet

This reference sheet is a tool for indexing the ONEBridge™ and ONE Respiratory Belt when using the ONEPlatform™ and iBEAM evo Couchtop Standard (415 mm) Extension with superior ends aligned.



| ONEPlatform or Universal Couchtop | ONEBridge on evo Couchtop | ONE Respiratory Belt on evo Couchtop |
|-----------------------------------|---------------------------|--------------------------------------|
| E 7 | - | 1A2, 0 |
| E 8 | 1A2, 1 | 1A2, 1 |
| E 9 | 1A2, 2 | 1A2, 2 |
| F 0 | 1A2, 3 | 1A2, 3 |
| F 1 | 1A2, 4 | 1A2, 4 |
| F 2 | 1A2, 5 | 1A2, 5 |
| F 3 | 1A2, 6 | 1A2, 6 |
| F 4 | 1A2, 7 | A2B, 0 |
| F 5 | A2B, 1 | A2B, 1 |
| F 6 | A2B, 2 | A2B, 2 |
| F 7 | A2B, 3 | A2B, 3 |
| F 8 | A2B, 4 | A2B, 4 |
| F 9 | A2B, 5 | A2B, 5 |
| G 0 | A2B, 6 | A2B, 6 |
| G 1 | A2B, 7 | 2B3, 0 |
| G 2 | 2B3, 1 | 2B3, 1 |
| G 3 | 2B3, 2 | 2B3, 2 |
| G 4 | 2B3, 3 | 2B3, 3 |
| G 5 | 2B3, 4 | 2B3, 4 |
| G 6 | 2B3, 5 | 2B3, 5 |
| G 7 | 2B3, 6 | 2B3, 6 |
| G 8 | 2B3, 7 | B3C, 0 |
| G 9 | B3C, 1 | B3C, 1 |
| H 0 | B3C, 2 | B3C, 2 |
| H 1 | B3C, 3 | B3C, 3 |
| H 2 | B3C, 4 | B3C, 4 |
| H 3 | B3C, 5 | B3C, 5 |
| H 4 | B3C, 6 | B3C, 6 |
| H 5 | B3C, 7 | 3C4, 0 |
| H 6 | 3C4, 1 | 3C4, 1 |
| H 7 | 3C4, 2 | 3C4, 2 |
| H 8 | 3C4, 3 | 3C4, 3 |
| H 9 | 3C4, 4 | 3C4, 4 |
| I 0 | 3C4, 5 | 3C4, 5 |
| I 1 | 3C4, 6 | 3C4, 6 |
| I 2 | 3C4, 7 | C4D, 0 |
| I 3 | C4D, 1 | C4D, 1 |
| I 4 | C4D, 2 | C4D, 2 |
| I 5 | C4D, 3 | C4D, 3 |

| cont'd ONEPlatform or Universal Couchtop | ONEBridge on evo Couchtop | ONE Respiratory Belt on evo Couchtop |
|---|---------------------------|--------------------------------------|
| I 6 | C4D, 4 | C4D, 4 |
| I 7 | C4D, 5 | C4D, 5 |
| I 8 | C4D, 6 | C4D, 6 |
| I 9 | C4D, 7 | 4D5, 0 |
| J 0 | 4D5, 1 | 4D5, 1 |
| J 1 | 4D5, 2 | 4D5, 2 |
| J 2 | 4D5, 3 | 4D5, 3 |
| J 3 | 4D5, 4 | 4D5, 4 |
| J 4 | 4D5, 5 | 4D5, 5 |
| J 5 | 4D5, 6 | 4D5, 6 |
| J 6 | 4D5, 7 | D5E, 0 |
| J 7 | D5E, 1 | D5E, 1 |
| J 8 | D5E, 2 | D5E, 2 |
| J 9 | D5E, 3 | D5E, 3 |
| K 0 | D5E, 4 | D5E, 4 |
| K 1 | D5E, 5 | D5E, 5 |
| K 2 | D5E, 6 | D5E, 6 |
| K 3 | D5E, 7 | 5E6, 0 |
| K 4 | 5E6, 1 | 5E6, 1 |
| K 5 | 5E6, 2 | 5E6, 2 |
| K 6 | 5E6, 3 | 5E6, 3 |
| K 7 | 5E6, 4 | 5E6, 4 |
| K 8 | 5E6, 5 | 5E6, 5 |
| K 9 | 5E6, 6 | 5E6, 6 |
| L 0 | 5E6, 7 | E6F, 0 |
| L 1 | E6F, 1 | E6F, 1 |
| L 2 | E6F, 2 | E6F, 2 |

Global Sales Office

Orange City, Iowa, USA

800.842.8688 | +1 712.737.8688

info@CivcoRT.com

www.CivcoRT.com

